

Mausoleum Expansion

MOUNT OLIVET CEMETERY
3801 WEST MORGAN AVENUE
MILWAUKEE WISCONSIN
414 645 0611

Introductory Overview

The Catholic Cemeteries of the Archdiocese of Milwaukee announce a new mausoleum project — the expansion of the mausoleum at Mount Olivet Cemetery in Milwaukee, comprising almost 2,200 new crypts and over 650 niches for cremation urns.



As the Archdiocesan Catholic cemetery for the parishes in southwest Milwaukee County, Mount Olivet enters a fifth phase of mausoleum construction. The last phase brought the Chapel of Angels & Light Mausoleum into existence.

Why A Catholic Cemetery?

A Catholic cemetery serves the Church through the ministry of consolation — reverent burial of the faithful departed and compassionate care of the living faithful. We extend this care to all God's people...no matter their station in life...as a sign of Christ's unconditional love and gentle mercy. We also assist people in facing the eventuality of their own deaths in a context of faith...faith in eternal life.

Mount Olivet shows the reality of the Communion of Saints. As sacred burial grounds, everything about this Cemetery furthers Catholic burial practices and liturgy. Everything supports a tradition of faith encouraging visitation and prayer.

For years Catholics have chosen Mount Olivet Cemetery...

*where love is remembered...hope is rekindled...
faith is awakened, renewed and strengthened.*

**WITH THE SAVINGS OF PRE-CONSTRUCTION PRICES,
IS IT TIME TO COMPLETE BURIAL PLANNING...
Now?**

An Opportunity To Finish Your Advance Burial Planning

Four Project Components

Two new additions will flank the Chapel of Angels & Light Mausoleum. Constructing a fourth free-standing mausoleum will complete the set of outdoor patios, and a niche feature will finish and enhance the eastern courtyard. So, there are four parts to a single expansion project.

1. Addition A lower right of plan

This portion will add three new interior corridors and two patios as the Chapel expands to the south. Niches are also included.

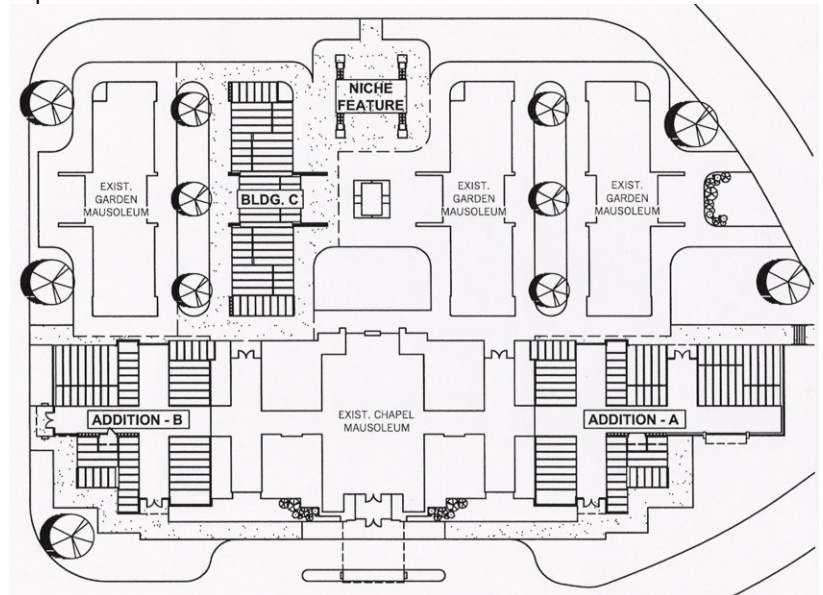

Note: **North** is to left on plan

2. Addition B lower left of plan

On the north side of the chapel, this expansion wing will include three inside corridors along with two outside patios. Interior niches are part of this addition.

3. Building C left center of plan

To complete our long-range plan, we are adding the last outside patio building to match the three existing buildings, adding four new patios of crypts and niches.

4. Niche Feature upper center of plan

To complement the existing Archangel Columbarium, we will build a 304-niche feature columbarium in the courtyard. As a new option, many niches throughout the expansion will be double-wide — “deluxe companion” niches.

Why is this happening?

We want to meet the need for above-ground burial space on the south side of Milwaukee, a place where preference for crypts and niches has been strong since the 1970s. Of course, we have always offered graves for in-ground burial.

These pre-need crypts and niches present an opportunity for cost savings while completing your advance burial arrangements. We are offering pre-construction pricing at substantial savings if you purchase pre-need. Bear in mind, if an untimely death occurs before completion of the new crypts or niches, a temporary



placement will be provided until the permanent placement can be made in the newly-constructed space.

Pre-Construction Sales opened on October 15, 2006.

Burial Options

Full-Body Above-Ground

- ❖ Single Crypts
- ❖ “True Companion” Crypts (*two spaces, end-to-end*)
- ❖ “Deluxe Companion” Crypts (*two spaces, side-by-side*)
- ❖ Family Crypts (*two to four spaces in large chamber*)

Cremated Remains Above-Ground

- ❖ Single Niches
- ❖ “Deluxe Companion” Niches (*two spaces, side-by-side*)

► **Contact the Family Service Counselor at Mount Olivet Office,**

**3801 W. Morgan Avenue
or 414 645 0611.**

► **Fill out and mail back the pre-paid reply card to get more detailed information or to initiate a meeting.**

► **Visit www.cemeteries.org for more information.**



The Benefits of Pre-planning

Make advance arrangements for cemetery burial...

- ❖ *with those you love...*
- ❖ *at a convenient time...*
- ❖ *for an affordable price...*
- ❖ *in a thoughtful manner...*
- ❖ *free of pressure...*
- ❖ *at a comfortable pace.*

1. Make your final choices responsibly...in advance.

As you have dealt responsibly with all dimensions of life, it makes sense to do this work *now* concerning your final affairs.

2. Take your time, but take the time.

By acting now, a spouse or family member can be spared difficult decisions...perhaps alone...at an emotional, stressful time.

3. Spend what you judge is right.

After a death, there is always a tendency to feel that “nothing is too good.” Sorrow can tend to overspend.

4. Locations in a cemetery are unique.

By purchasing now, you will secure a preferred burial location. A special place in a particular cemetery might be gone if you wait.

5. Prices do not go down.

You can get the best possible price today. All cemetery costs and fees can be prepaid.

6. Treat yourself to peace of mind.

By putting all things in order, you have helped make a future difficult time less complicated and the present time more contented.

7. Accepting your mortality is trusting God.

Advance burial arrangements settle an important area of future concern. You express love and compassion for the people in your life: they know they will be carrying out your clear preferences. Not hopeless...you put your faith in Christ.

8. Continue in death what you believed in life.

A Catholic cemetery is the gathering of those who died in faith, still united with the living in God’s eyes...the Communion of Saints.



Let us know your intentions by making contact with us.